

#8736

SHRINK WRAP SEALER
300SP 450SP 600SP
300IP 450IP 600IP 800IP
INSTRUCTION

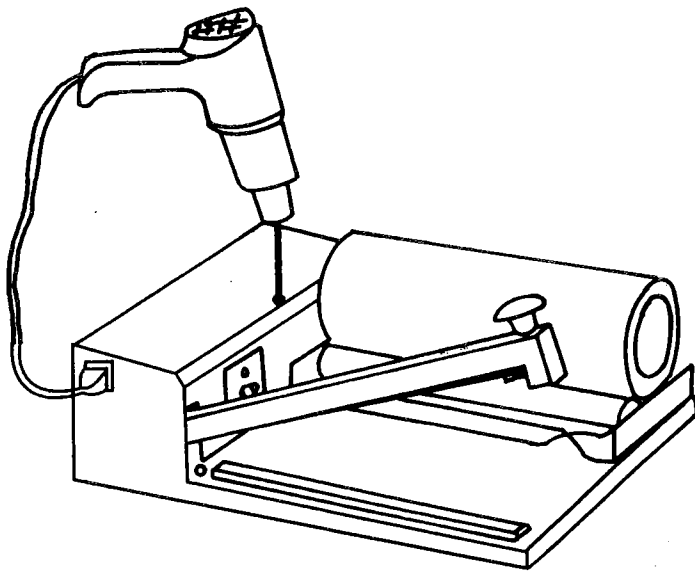

1 INSTRUCTION BOOKLET

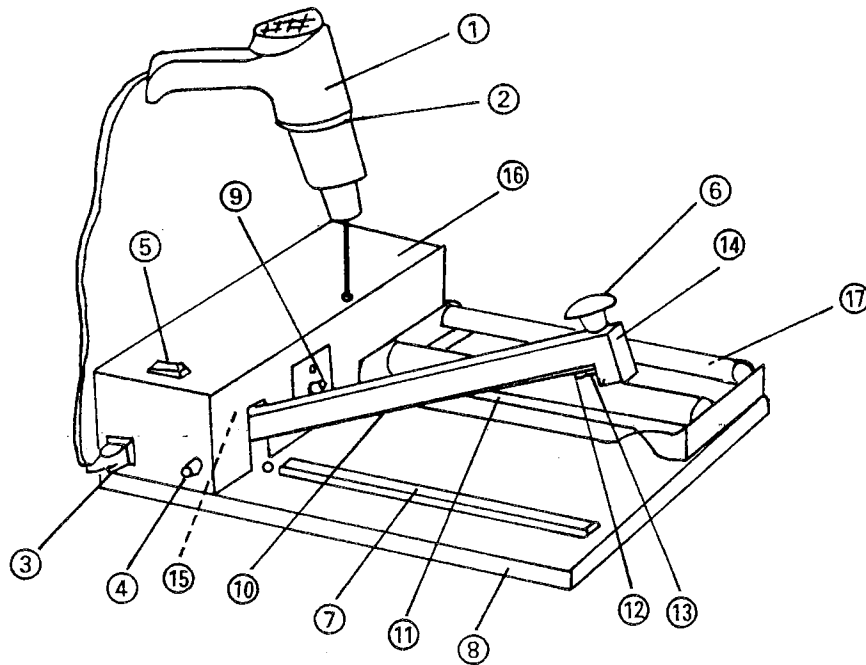

- | | |
|--------------------|------------------------------|
| ① HEAT GUN | ⑨ TIMER KNOB |
| ② HEAT GUN BRACKET | ⑩ HEATING ELEMENT |
| ③ AC OUTLET | ⑪ TEFLON TAPE |
| ④ FUSE BRACKET | ⑫ HEATING ELEMENT ATTACHMENT |
| ⑤ POWER SWITCH | ⑬ WASHER FOR HEATER |
| ⑥ HANDLE KNOB | ⑭ PLATEN ARM |
| ⑦ SEALING SILICON | ⑮ PLATEN SPRING |
| ⑧ BASE PLATE | ⑯ ENCLOSURE |
| | ⑰ ROLLER |

2 OPERATING INSTRUCTION

(1) SET POWER SWITCH TO "ON" POSITION.

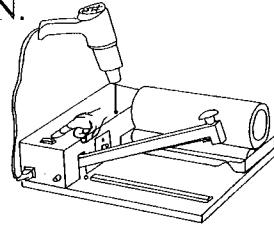

(2) SET SEALING TIMER ACCORDING TO THE SHRINK FILM THICKNESS.

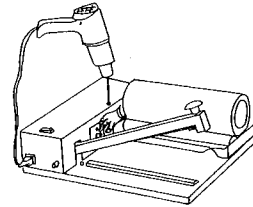

(3) PLACE THE OBJECT IN BETWEEN SHEETS OF THE FILM AND SEAL.

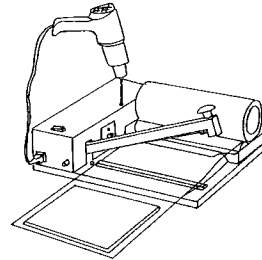

(4) TEAR THE RESULTING BAG FROM THE REST AND SEAL THE OPENING.

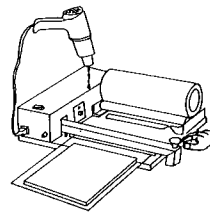

(5) USE THE HEAT GUN TO EVENLY SHRINK THE FILM.

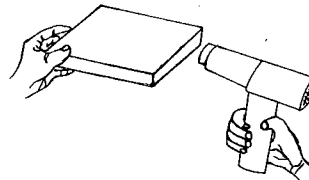

3 SPECIFICATIONS

MODEL	300SP/IP	450SP/IP	600SP/IP	800IP
SOURCE	120V-240V	120V-240V	120V-240V	120V-240V
POWER	250W	350W	450W	500W
SEALING TIMER	1.0-4SEC	1.0-4SEC	1.0-4SEC	1.0-4SEC
MAX SEAL LENGTH	330mm	450mm	600mm	800mm
WEIGHT	9Kg	10Kg	11Kg	12Kg
DIMENSIONS	44x52x15cm	44x68x15cm	44x82x15cm	44x98x15cm
HEAT GUN WATTS	600W/1200W	600W/1200W	600W/1200W	600W/1200W

4 CONNECTION DIAGRAM

CONNECTION DIAGRAM

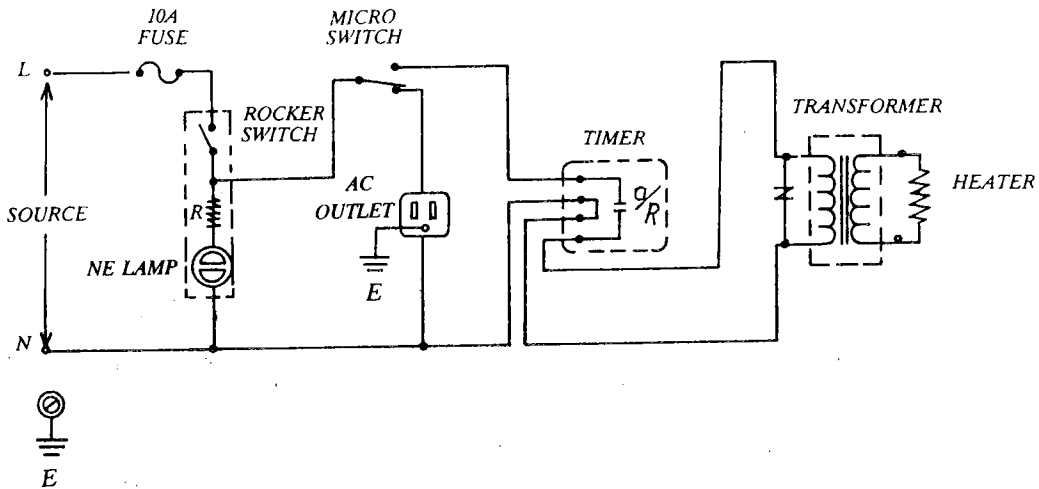

5 HELPFUL INFORMATION

- Always keep the sealing platform clean. Particular care 'should' be taken to remove any residue from the teflon tape.
- Do not clean the sealing platform with anything wet.
- When replacing the heating element always check the condition of the bottom teflon tape. It is important that you replace the element wire only with the one made for this machine. You can damage the transformer with the wrong element wire.
- Occasionally check the condition of the bottom pad (silicon rubber) for wear or burn. A poor rubber pad will effect the quality of your seal.

6 SPARE PARTS

ASSESSORIES	Q'TY
HEAING ELEMENT	1
FUSE	10Ax1
UPPER TEFLON CLOTH	2
LOWER HEATER CLOTH	1

7 CHANGING PARTS

REMOVE PLUG FROM ELECTRIC OUTLET

REPLACING HEATING ELEMENT WIRE

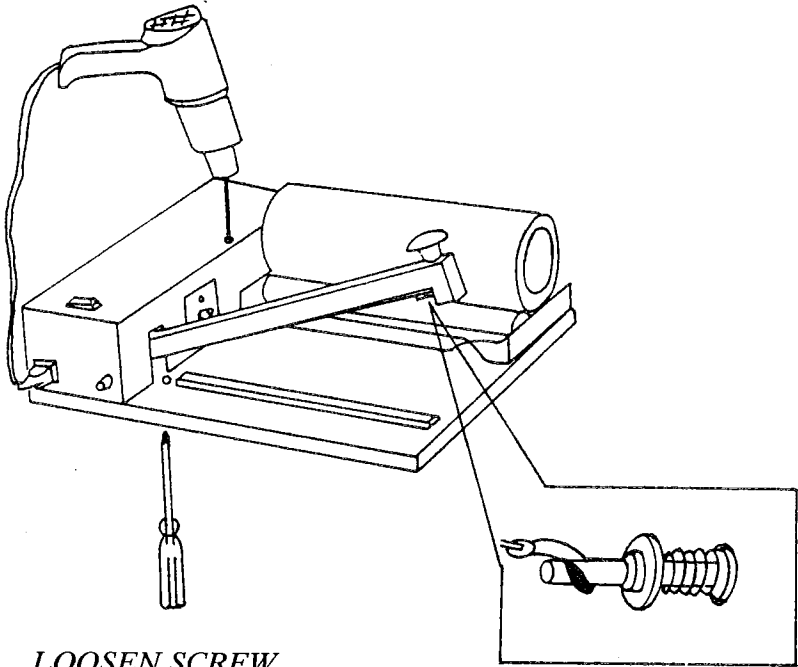

LOOSEN SCREW

HEATER TERMINAL ASSEMBLY

(a) Loosen teflon remove pressing teflon.

(b) Lift up teflon and remove broken element wire from heater spring boss.

(c) Another heater wire terminal put on platen arm by screw.

(d) Put new element wire on heater spring boss and platen arm screw donot bend.(DO NOT BEND OR CRIMP THE WIRE)

(e) Replace teflon on the heater wire.

8 CAUTIONARY MARKINGS

CAUTION -To reduce the risk of shock, disconnect the unit from the supply circuit before servicing the replacement of the heating element.

-To provide continued protection against risk of electric shock, connect to properly grounded outlet only.

-A live heating element is located in the arm under the teflon tape. Use caution during operation. **DO NOT TOUCH THE ELEMENT.**

WARNING -For Continued Protection Against Fire or Electric shock, Replace Only With Type Cartridge and 10 Ampere Fuse., Provided in legible adjacent to fuseholder.